

EAO – Your Expert Partner for Human Machine Interfaces

14-415.036K - Keylock switch actuator 2 positions

14-415.036K - Keylock switch actuator 2 positions

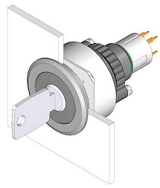

Attention: The preview is based on a sample product. This can differ from your current configuration.

Mounting

Design flush
Mounting cut-out Ø 30,5 mm

Front

Front dimension Ø 35 mm
Front shape round

Other Attributes

Weight 0,030 kg

Operating-/Indication part

Switching angle 90° right

IP-Rating

Front protection IP65

Connection Method

Terminal Universal 2.0 x 0.5 mm

Actuator

Switching action Rest(a) - Maintain

Switching element

Rotary positions 2
Switching system Low-level element
Contacts 1 NC + 1 NO
Switching voltage 42 V AC/DC
Switching current 0.1 A
Contact material

Function

Keylock switch

EAO – Your Expert Partner for Human Machine Interfaces

14-415.036K - Keylock switch actuator 2 positions

Dimensions

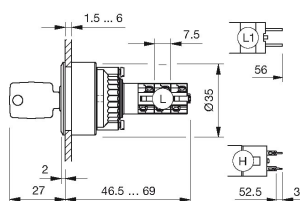

H = Universal terminal 2.0 x 0.5 mm

Mounting cut-outs

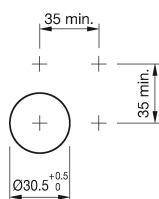

Wiring diagram



Component layout

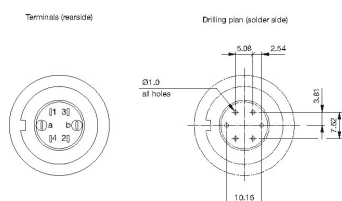

Additional information

Lock numbers 1001, lock type KABA
Two keys are supplied with each keylock switch.
Optional lock numbers on request

Legend

Contacts: NC = Normally closed, NO = Normally open
Switching action: A = Rest, C = Maintained

EAO – Your Expert Partner for Human Machine Interfaces

14-415.036K - Keylock switch actuator 2 positions

Switching positions

