

SHIELDED 9 VOLT BATTERY STRAPS

- Insulates and shields 9 Volt battery snap-on connector contacts
- Assures safe secure use, reduces the potential of short circuits and prevents tampering with battery contacts
- Protects circuits, prevents unwanted electrical discharge due to unintended grounding
- Protects battery contacts from dust, dirt, and physical damage
- Ideal for rugged applications, made of high impact molded plastic with integral wire lead strain relief

Modifications available with different wire lengths.

SPECIFICATIONS

Base: ABS
Male/Female Contacts: Brass, Nickel Plate
Wires (Red & Black): #26 AWG, Tinned, .187 (4.8) end strip, UL/CSA1007
 *Tolerance on lead length +/- .250 (6.4)

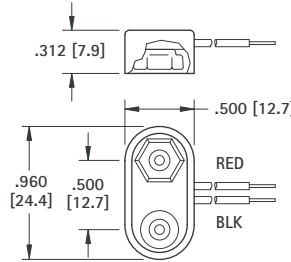
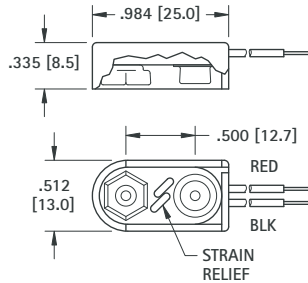

I STYLE		T STYLE	
MOLDED		MOLDED	
CAT. NO.	*LEAD LENGTH	CAT. NO.	*LEAD LENGTH
84-4	4.00 (101.6)	81-4	4.00 (101.6)
84-6	6.00 (152.4)	81-6	6.00 (152.4)
84-8	8.00 (203.2)	81-8	8.00 (203.2)

PREMIUM 9 VOLT BATTERY STRAPS

- Fully Assembled
- Rigid Assembly
- Ideal for rugged applications, made of high impact molded plastic with integral wire lead strain relief

Rigidly constructed. Nickel plate, male and female contacts. Female contacts are spring temper. Accepts numerous insertions to meet U.L. approved standards. Provides excellent mechanical strength and low contact resistance. Wires have tinned copper conductors, PVC insulation and the ends are stripped for easy connection.

Wires are rated to +176°F (+80°C) and 300V and meet UL/CSA #1061/#1007 requirements.

Modifications available with different wire lengths.

SPECIFICATIONS

Contacts: Phosphor Bronze, Nickel Plate
Wire: #26 AWG, 7/34
End Strip: .250 (6.4) Long, Tinned
Base: Polyethylene
 *Tolerance on lead length +/- .250 (6.4)



Base Size:
1.062 (27.0) x .512 (13.0)

I STYLE		T STYLE	
MOLDED		MOLDED	
CAT. NO.	*LEAD LENGTH	CAT. NO.	*LEAD LENGTH
2238	4.00 (101.6)	2241	4.00 (101.6)
2239	6.00 (152.4)	2242	6.00 (152.4)
2240	8.00 (203.2)	2243	8.00 (203.2)



Base Size:
1.00 (25.4) x .512 (13.0)

ECONOMY 9 VOLT BATTERY STRAPS

- Fully Assembled
- Rigid Assembly

When product cost is of the utmost importance these economy battery straps will suit your needs. Brass contacts, nickel plated with vinyl or ABS covering. Wires have tinned copper conductors, PVC insulation and the ends are stripped for easy connection. Wires meet UL/CSA #1007 requirements.

Modifications available with different wire lengths

SPECIFICATIONS

Contacts: Brass, Nickel Plate
Wire: #26 AWG, 7/34
End Strip: .250 (6.4) Long, Tinned
 *Tolerance on lead length +/- .250 (6.4)

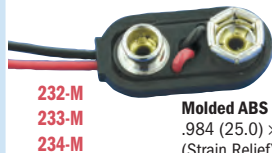

Molded ABS Base Size:
.984 (25.0) x .469 (11.9)
(Strain Relief)

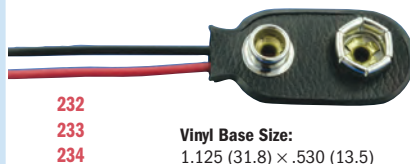

Vinyl Base Size:
1.125 (31.8) x .530 (13.5)

I STYLE		T STYLE		
MOLDED	VINYL	MOLDED	VINYL	
CAT. NO.	CAT. NO.	*LEAD LENGTH	CAT. NO.	
232-M	232	4.00 (101.6)	235-M	235
233-M	233	6.00 (152.4)	236-M	236
234-M	234	8.00 (203.2)	237-M	237



Molded ABS Base Size:
.965 (25.0) x .469 (11.9)
(Strain Relief)

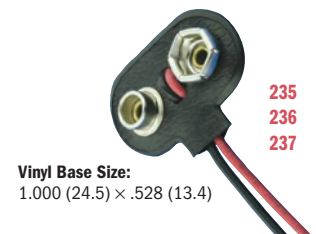

Vinyl Base Size:
1.000 (24.5) x .528 (13.4)

PREMIUM 9 VOLT BATTERY STRAPS

FIBRE BASE

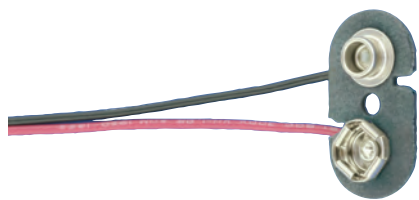

CAT. NO.	*LEAD LENGTH
68	NONE
72-4	4.00 (101.6)
72	7.00 (177.8)
72-8	8.00 (203.2)

Base Size:
1.025 (26.0) × .535 (13.6)
.062 (1.57) thick
Contacts: Steel, Nickel Plate
Wire: #22 AWG, 7/30 Prebond
End Strip: .375 (9.5) Long, Tinned

*Tolerance on lead length +/- .250 (6.4)

FIBRE BASE

- Fully Insulated
- Flexible assembly

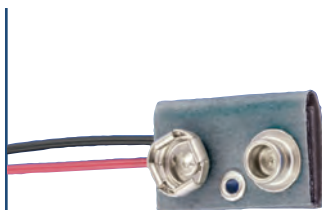

Cover Size:
.900 (22.9) × .575 (14.6)
Contacts: Steel., Nickel Plate
Wire: #22 AWG, 7/30 Prebond
End Strip: .375 (9.5) Long, Tinned

*Tolerance on lead length +/- .250 (6.4)

I - STYLE

CAT. NO.	*LEAD LENGTH
83-4	4.00 (101.6)
83	6.50 (165.1)
83-8	8.00 (203.2)

Cover Size:
.900 (22.9) × .575 (14.6)
Contacts: Steel., Nickel Plate
Wire: #22 AWG, 7/30 Prebond
End Strip: .375 (9.5) Long, Tinned

*Tolerance on lead length +/- .250 (6.4)

T - STYLE

CAT. NO.	*LEAD LENGTH
85-4	4.00 (101.6)
85-6	6.50 (165.1)
85-8	8.00 (203.2)

VERTICAL 9 VOLT PC SNAP-ON CONTACT

- Space saving, economical
- Excellent mechanical strength
- Low contact resistance
- Durable fibre base
- Wave solderable
- Anti-Wicking Design

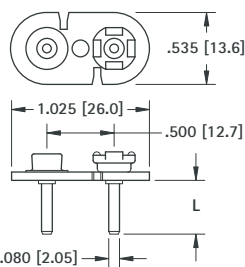

SPECIFICATIONS

Base: .062 (1.57) thick Fibre
Contacts: Steel, Nickel Plate
Pins: Brass, Tin Plate

CAT. NO.	L LENGTH
967 (with PC Pins)	.120 (3.0)
968 (with PC Pins)	.400 (10.2)

Mounting Detail

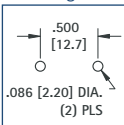

9 VOLT SNAP-ON CONTACT

- Cost saving design
- Ideal for custom applications
- Attach your own terminals and wire leads

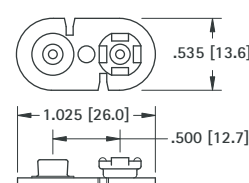

SPECIFICATIONS

Base: .062 (1.57) thick Fibre
Contacts: Steel, Nickel Plate

CAT. NO. 68 (without PC Pins)

DUAL 9 VOLT BATTERY STRAP

This dual battery strap is pre-wired for connecting two 9 Volt batteries. Base made from fibre material with steel, nickel plated contacts. Wires have tinned copper conductors, PVC insulation and the ends are stripped for easy connection. Wires meet UL/CSA #1061 requirements.

SPECIFICATIONS

Contacts: Steel, Nickel Plate
Wire: #22 AWG, 7/30 Prebond
End Strip: .375 (9.5) Long, Tinned

CAT. NO.	*LEAD LENGTH
227	7.00 (177.8)

*Tolerance on lead length +/- .250 (6.4)

PARALLEL

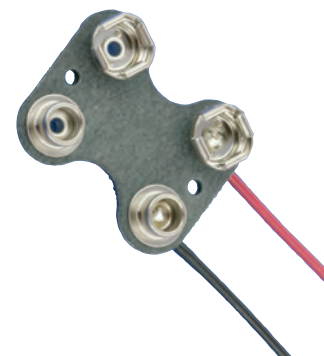
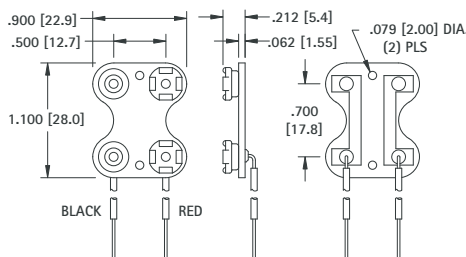

PROTECTIVE BATTERY CAP

- Protects 9 Volt batteries and battery packs when they are not in use
- Snap-fits onto battery contacts
- Both male and female contacts are covered, minimizing physical damage which can occur during battery handling, shipping and storage
- Shields the battery contacts and reduces the potential of a short circuit between battery poles
- Protects sensitive electronic equipment, systems and circuits, cap prevents unwanted electrical discharges
- Protects the battery contacts from damage due to dust, dirt and contamination

MATERIAL:

Impact Resistant Polypropylene, Black

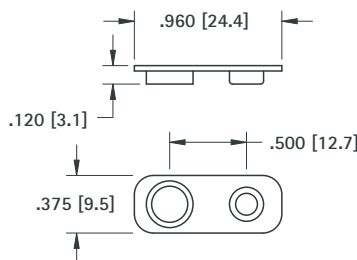

CAT. NO. 96