

EAO – Your Expert Partner for Human Machine Interfaces

01-421.036 - Illuminated pushbutton actuator

01-421.036 - Illuminated pushbutton actuator



Attention: The preview is based on a sample product. This can differ from your current configuration.

Mounting

Mounting cut-out Ø 16 mm
Design raised

Front

Front dimension 18 mm x 24 mm
Front shape rectangular
Front bezel colour black
Front bezel material Plastic

Other Attributes

Weight 0,009 kg

Operating-/Indication part

Lens illumination illuminative

IP-Rating

Front protection IP40

Connection Method

Terminal Universal 2.0 x 0.5 mm

Actuator

Switching action Momentary
Housing colour black
Housing material Plastic

Switching element

Switching system Low-level element
Contacts 2 NO
Switching voltage 42 V AC/DC
Switching current 0.1 A
Contact material

Function

Illuminated pushbutton

EAO – Your Expert Partner for Human Machine Interfaces

01-421.036 - Illuminated pushbutton actuator

Dimensions

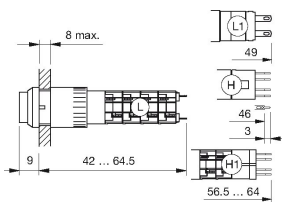

Mounting cut-outs

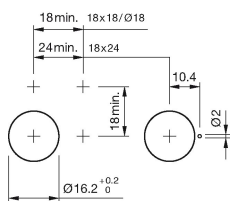

Wiring diagram

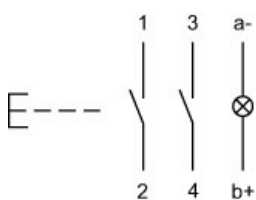

Component layout

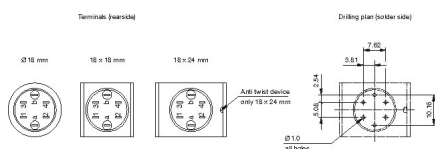

Legend

Contacts: NO = Normally open
Switching action: A = Rest, B = Momentary