

NOTE:  
 1.MATERIAL:  
 HOUSING: POLYESTER GLASS FILLED,UL94-V0,COLOR:SEE LEGEND.  
 TERMINAL: PHOSPHOR BRONZE  
 METAL SHELL: SPCC  
 BOARD LOCK: BRASS  
 SCREW: BRASS  
 2.PLATING:  
 TERMINAL:  
 CONTACT AREA: SEE PART NUMBER LEGEND  
 SOLDER TAIL: TIN(Sn),THICKNESS=100 MICREINCH MIN/2.54 MICROMETER MIN.  
 UNDER PLATE: NICKEL(Ni) PLATED OVERALL.  
 METAL SHELL: TIN (Sn),THICKNESS=100 MICREINCH MIN/2.54 MICROMETER MIN.  
 UNDER PLATE: COPPER(Cu) PLATED OVERALL.  
 BOARD LOCK: TIN (Sn),THICKNESS=50 MICREINCH MIN/1.27 MICROMETER MIN.  
 SCREW: NICKEL(Ni) PLATED OVERALL.

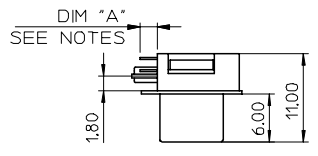

3.2 PCS #4-40 SCREW ATTACHED  
 4.RECOMMANDED PCB THICKNESS: 1.60+/-0.05mm  
 5.PRODUCT SPECIFICATION: REFER TO PS-48203-001  
 6.TEST SUMMARY: REFER TO TS-89460-002  
 7.PACKAGING SPECIFICATION: REFER TO PK-89460-002  
 8.LEAD FREE AND ROHS COMPLIANCE PRODUCT  
 LEGEND : 89460-\*9\*\*

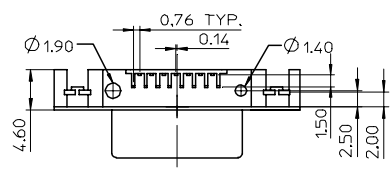
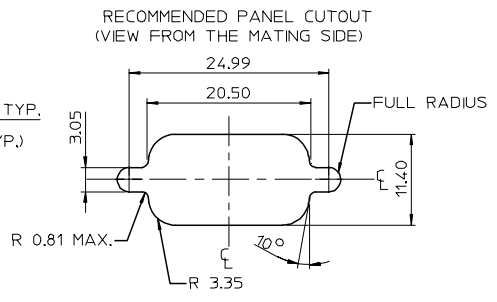
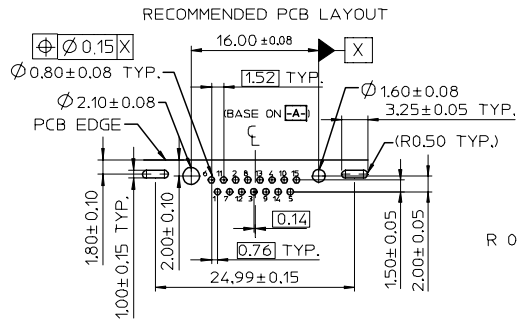

DIMENSION \*A\*  
 0-A=2.1mm  
 HOUSING COLOR:BLACK  
 1-A=3.0mm  
 HOUSING COLOR:BLUE(PC 99)  
 2-A=3.0mm  
 HOUSING COLOR:BLACK  
 HEX SCREW OPTION:  
 1-WITHOUT #4-40 SCREW  
 3-WITH 2 PCS #4-40 SCREW  
 (NON-ASSEMBLED)  
 CONTACT PLATING CODE:  
 4-0.76 MICROMETER GOLD MINIMUM  
 5-0.38 MICROMETER GOLD MINIMUM  
 6-GOLD FLASH

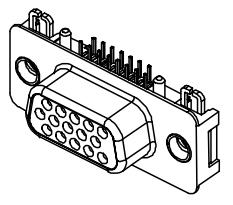

LEAD FREE FOR 89460	2006/03/31	DESCRIPTION
EC NO: SH2006-0443	2006/03/31	REV
DRWN:ALLIN	2006/03/31	
CHKD:		
APPR:WMSCHANG	2006/03/31	

QUALITY SYMBOLS	▽=0
	▽=0

GENERAL TOLERANCES (UNLESS SPECIFIED)	mm	INCH
4 PLACES	± ---	± ---
3 PLACES	± ---	± ---
2 PLACES	± 0.25	± ---
1 PLACE	± 0.25	± ---
ANGULAR ± 3 °		
DRAFT WHERE APPLICABLE MUST REMAIN WITHIN DIMENSIONS		

DIMENSION STYLE		SCALE	DESIGN UNITS	THIRD ANGLE PROJECTION
MM ONLY			METRIC	
DRAWN BY	DATE	TITLE		
LINDA	2005/08/15	HIGH DENSITY D-SUB 15 CKT ULTRA SLIM FEMALE (LEAD FREE VERSION)		
CHECKED BY	DATE			
ALLEN LIN	2005/08/15			
APPROVED BY	DATE			
WILSON CHANG	2005/08/15			
MATERIAL NO.	DOCUMENT NO.			
	SD-89460-002			
SIZE	THIS DRAWING CONTAINS INFORMATION THAT IS PROPRIETARY TO MOLEX INCORPORATED AND SHOULD NOT BE USED WITHOUT WRITTEN PERMISSION			
A3				

MOLEX INCORPORATED		SHEET NO.
		1 OF 1