

Thomas & Betts

Thomas & Betts offers a wide variety of conduit bodies to fit all your wire-pulling needs!

T&B® Fittings

Series 35 Conduit Outlet
Bodies and Covers



***Ideal for any of your rigid
conduit applications!***



Series 35 Conduit Outlet Bodies and Covers

Completely Interchangeable with Other Manufacturers' 35/5 Series Iron and Steel Conduit Outlet Bodies and Covers

Thomas and Betts offers you the very best for your wire-pulling needs with its Series 35 Conduit Outlet Bodies and Covers. Made from zinc-plated iron, these conduit bodies act as mounting outlets, while providing access to conductors for maintenance and future system changes. Not only do they protect the conduit running through now, but they also provide easy access later when you need to service the conduit.

Ideal for use in MRO and industrial or commercial construction projects to:

- Connect conduit sections
- Serve as pulling outlets during conductor installation
- Provide easy access for splices in branch conductors
- Make 90° bends in conduit runs
- Act as mounting outlets for wiring devices and lighting fixtures
- Provide access to conductors for maintenance and future system changes

Features

- Zinc-plated iron construction with aluminum acrylic coating provides durability, impact resistance and corrosion resistance
- Available in sizes from ½" to 4" in Types C, LB, LL, LR and T
- Available in sizes from ½" to 2" in Types TB and X
- Features tapered, threaded NPT hubs
- Suitable for use in concrete
- Covers available in iron or stamped steel, both zinc-plated and supplied with stainless steel captive screws
- Steel covers feature raised dome for additional wiring room



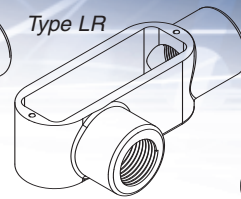
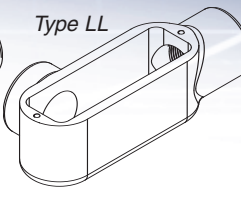
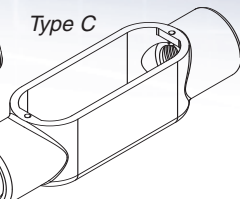
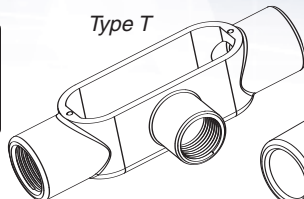
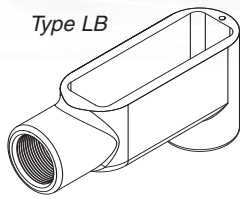

Series 35 Conduit Outlet Bodies and Covers

Cat. No.	Size	Dimensions			Internal Volume (Cu. In.)	Std. Pkg. Qty.	UPC No.
		A	B	C			

Series 35 Conduit Body Type LB (Back Opening)

LB50M	½"	1.34	4.68	2.05	4.5	10	786210-96052
LB75M-TB	¾"	1.50	5.37	2.25	7.5	10	786210-96053
LB100M	1"	1.80	6.20	2.65	12.5	10	786210-96059
LB125M	1¼"	2.60	8.12	2.75	32	5	786210-96060
LB150M	1½"	2.60	8.12	2.83	35.3	5	786210-96061
LB200M	2"	3.12	10.50	4.42	73	1	786210-96066
LB250M	2½"	4.31	13.60	5.40	142	1	786210-96067
LB300M	3"	4.31	13.87	5.90	173	1	786210-96068
LB350M	3½"	5.62	16.25	6.90	292	1	786210-96069
LB400M	4"	5.62	16.60	7.21	324	1	786210-96070

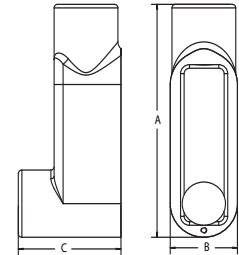

Type LB

Series 35 Conduit Body Type T ("T"-Style)

T50M	½"	2.05	5.38	1.34	6	10	786210-96071
T75M	¾"	2.25	6.00	1.50	9.5	10	786210-96072
T100M	1"	2.65	7.05	1.80	15	10	786210-96073
T125M	1¼"	2.75	9.00	2.60	33	5	786210-96075
T150M	1½"	3.50	9.00	2.60	36	5	786210-96076
T200M	2"	4.12	11.50	3.12	76	1	786210-96077
T250M	2½"	5.71	15.00	4.31	142	1	786210-96078
T300M	3"	5.87	15.12	4.31	173	1	786210-96079
T350M	3½"	6.81	18.13	5.19	292	1	786210-96081
T400M	4"	7.15	18.13	5.56	324	1	786210-96083

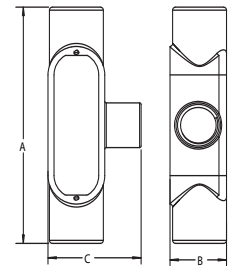

Type T

Series 35 Conduit Body Type C (Thru-Feed)

C50M	½"	1.34	5.38	1.37	4.5	10	786210-96192
C75M-TB	¾"	1.50	6.00	1.70	7.5	10	786210-96193
C100M	1"	1.80	7.05	1.90	12.5	10	786210-96194
C125M	1¼"	2.60	9.00	2.75	35	5	786210-96196
C150M	1½"	2.60	9.00	2.83	35.3	5	786210-96201
C200M	2"	3.12	11.50	3.31	75	1	786210-96202
C250M-TB	2½"	4.31	15.00	3.90	153	1	786210-96203
C300M	3"	4.31	15.12	4.75	181	1	786210-96204
C350M	3½"	4.88	18.13	5.19	290	1	786210-96205
C400M	4"	4.88	18.13	5.56	320	1	786210-96207

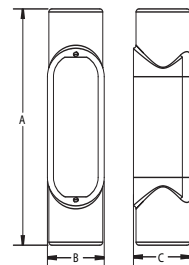

Type C

Series 35 Conduit Body Type LL (Left-Side Opening)

LL50M	½"	2.05	4.68	1.37	4.5	10	786210-96124
LL75M	¾"	2.25	5.37	1.70	7.5	10	786210-96125
LL100M	1"	2.65	6.20	1.90	12.5	10	786210-96127
LL125M	1¼"	2.75	8.12	2.75	32	5	786210-96128
LL150M	1½"	3.50	8.12	2.83	33	5	786210-96133
LL200M	2"	4.12	10.50	3.31	68	1	786210-96134
LL250M	2½"	5.71	13.60	3.90	142	1	786210-96135
LL300M	3"	5.87	13.87	4.75	173	1	786210-96148
LL350M	3½"	7.13	16.50	6.81	292	1	786210-96149
LL400M	4"	7.13	16.50	7.19	324	1	786210-96150

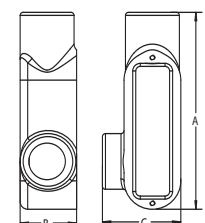

Type LL

Series 35 Conduit Body Type LR (Right-Side Opening)

LR50M	½"	2.05	4.68	1.37	4.5	10	786210-96154
LR75M	¾"	2.25	5.37	1.70	7.5	10	786210-96164
LR100M	1"	2.65	6.20	1.90	12.5	10	786210-96165
LR125M	1¼"	2.75	8.12	2.75	32	5	786210-96168
LR150M	1½"	3.50	8.12	2.83	35.3	5	786210-96176
LR200M	2"	4.12	10.50	3.31	68	1	786210-96179
LR250M	2½"	5.71	13.60	3.90	142	1	786210-96183
LR300M	3"	5.87	13.87	4.75	173	1	786210-96189
LR350M-TB	3½"	6.10	16.25	5.62	292	1	786210-96190
LR400M	4"	6.95	16.25	5.62	324	1	786210-96191

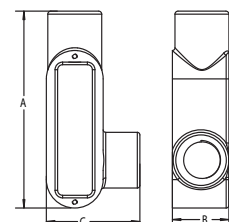

Type LR

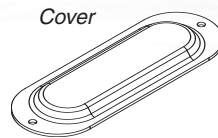
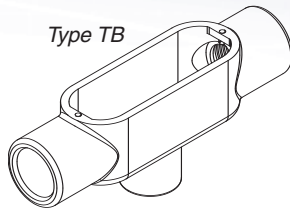
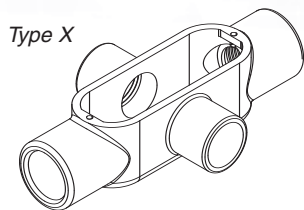

Series 35 Conduit Outlet Bodies and Covers

Cat. No.	Size	Dimensions			Internal Volume (Cu. In.)	Std. Pkg. Qty.	UPC No.
		A	B	C			
Series 35 Conduit Body Type X ("X"-Style)							
X50M	½"	2.79	5.41	1.75	36	5	786210-96092
X75M	¾"	2.93	6.08	1.97	76	5	786210-96093
X100M	1"	3.56	7.1	2.25	6	2	786210-96094
X125M	1¼"	4.43	9.1	2.55	9.5	1	786210-96095
X150M	1½"	4.43	9.1	2.75	15	1	786210-96096
X200M	2"	5.4	11.75	3.45	33	1	786210-96097

Series 35 Conduit Body Type TB (Thru-Feed with Bottom Tap)

TB50M	½"	1.34	5.38	2.05	6	10	786210-96084
TB75M	¾"	1.50	6.00	2.25	9.5	10	786210-96085
TB100M	1"	1.80	7.05	2.65	15	10	786210-96086
TB125M	1¼"	2.60	9.00	2.75	33	5	786210-96105
TB150M	1½"	2.60	9.00	2.83	36	5	786210-96088
TB200M	2"	3.12	11.50	4.42	76	1	786210-96091

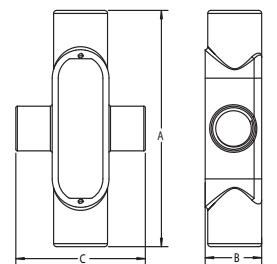

Type X

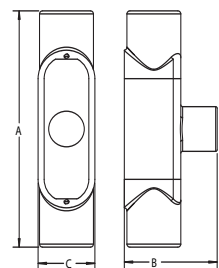

Type TB

Series 35 Gaskets — Neoprene

GK50N	½"	—	—	—	—	100	786210-98108
GK75N	¾"	—	—	—	—	100	786210-98109
GK100N	1"	—	—	—	—	50	786210-98110
GK125-150N	1¼"-1½"	—	—	—	—	25	786210-98111
GK200N	2"	—	—	—	—	25	786210-98112
GK250-300N	2½"-3"	—	—	—	—	25	786210-98113
GK350-400N	3½"-4"	—	—	—	—	25	786210-98114

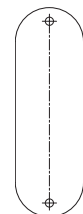

Gasket

Series 35 Iron Conduit Body Covers — Malleable Iron

K50M	½"	—	—	—	—	50	786210-98235
K75M	¾"	—	—	—	—	50	786210-98237
K100M	1"	—	—	—	—	25	786210-98238
K125M	1¼"-1½"	—	—	—	—	10	786210-98239
K200M	2"	—	—	—	—	5	786210-98240
K250M	2½"-3"	—	—	—	—	5	786210-98241
K350M	3½"-4"	—	—	—	—	5	786210-98242

Series 35 Steel Conduit Body Covers — Stamped Steel

K50S	½"	—	—	—	—	50	786210-96099
K75S	¾"	—	—	—	—	50	786210-96098
K100S	1"	—	—	—	—	25	786210-96100
K125S	1¼"	—	—	—	—	20	786210-96101
K200S	2"	—	—	—	—	5	786210-97693
K250S	2½"	—	—	—	—	5	786210-96103
K350S	3½"	—	—	—	—	5	786210-96104



Cover

www.tnb.com

Thomas & Betts

Please ask your Thomas & Betts sales representative for a complete catalog of quality Thomas & Betts electrical products or visit us at www.tnb.com. For customer service, call 1-800-816-7809. For technical questions, call 1-888-862-3289.

Thomas & Betts Corporation
Electrical Division
8155 T&B Boulevard
Memphis, TN 38125
901-252-5000

Thomas & Betts Ltd.
700 Thomas Avenue
Iberville, Québec J2X 2M9
450-347-5318