

NOTES:

- 1) MATERIALS:
HOUSING: GLASS-FILLED LCP (LIQUID CRYSTAL POLYMER)
UL 94 V 0, BLACK
TERMINALS: BRASS
BOARD LOCKS: PHOSPHOR BRONZE
METAL LATCHES: 302 STAINLESS STEEL.
- 2) FINISH:
TERMINALS:
.000030/(0.00076) MINIMUM GOLD IN CONTACT AREA AND
.000050/(0.00127) MINIMUM TIN IN TAIL AREA OVER
.000075/(0.00191) MINIMUM NICKEL UNDERPLATING OVERALL.
BOARD LOCKS:
.000050/(0.00127) MINIMUM TIN
- 3) ASSEMBLY MATES WITH MOLEX P/N SDA-71660-****,
CONFORMS TO PRODUCT SPECIFICATION PS-71660.
- 4) FOUR DIGIT DATE CODE (WK, YR), EXAMPLE => 26 96
LOCATED IN AREA INDICATED.

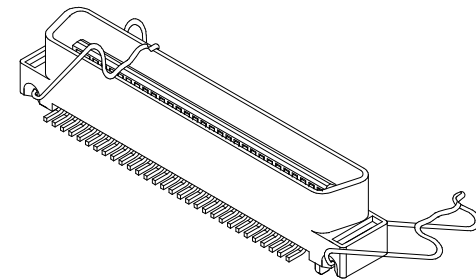
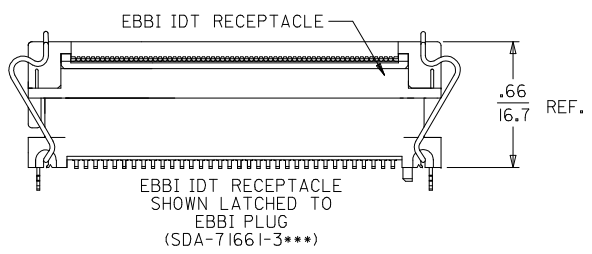
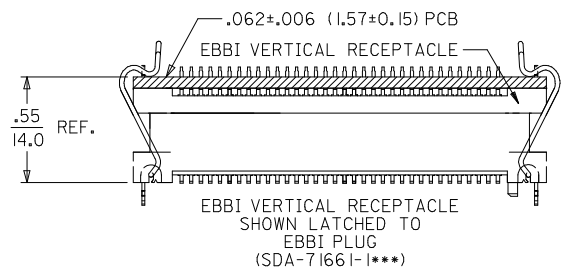
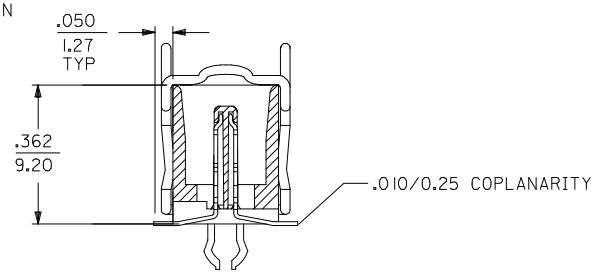
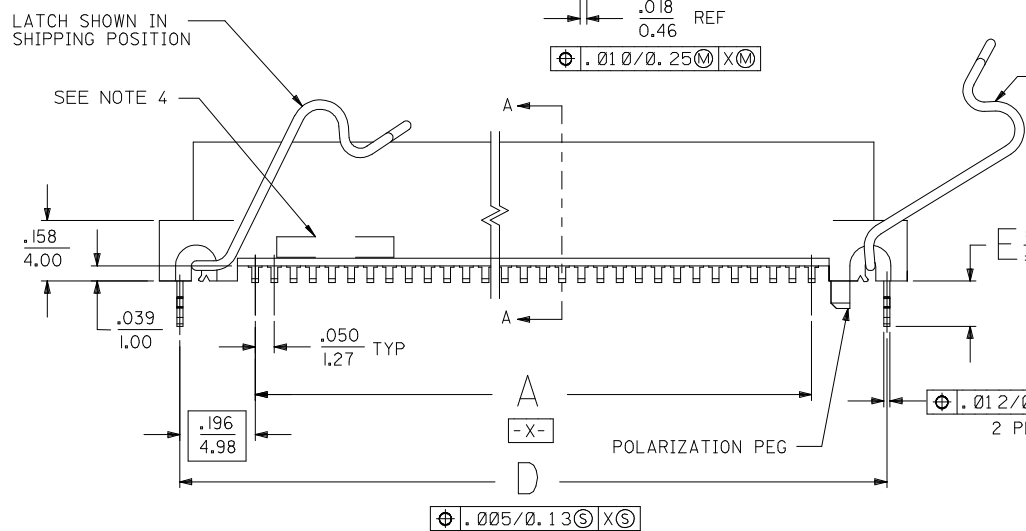

REFERENCE APPLICATION VIEWS

MOVE DATE CODE EC NO: UCP2013-1178 DRWIN:POFF 2012/09/24 CHKD:BBARKER 2012/09/24 APPR:SMILLER 2012/09/28	QUALITY SYMBOLS $\nabla = 0$ $\nabla = 0$ $\nabla = 0$	GENERAL TOLERANCES (UNLESS SPECIFIED)		DIMENSION STYLE IN/MM		SCALE	DESIGN UNITS INCH	THIRD ANGLE PROJECTION		
		4 PLACES $\pm .005$	3 PLACES $\pm .005$	2 PLACES ± 0.13	1 PLACE ± 0.25	0 PLACE $\pm .005$	DRAWN BY BSMART	DATE 01/20/2005	TITLE SALES ASSY EBBI 50D VERT SMT PLUG-WITH LATCHES, NO VAC CAP	
		ANGULAR $\pm 1/2^\circ$		DRAFT WHERE APPLICABLE MUST REMAIN WITHIN DIMENSIONS		APPROVED BY SMILLER		DATE 2012/09/28	DOCUMENT NO. SD-74139-002	
		MATERIAL NO. SEE TABLE		SHEET NO. 1 OF 2		THIS DRAWING CONTAINS INFORMATION THAT IS PROPRIETARY TO MOLEX INCORPORATED AND SHOULD NOT BE USED WITHOUT WRITTEN PERMISSION				

MATERIAL NUMBER	CKT	A	B	C	D	E	PCB THICKNESS	PACKAGING SPEC.
74139-5530	30	.700 (17.78)	.926 (23.52)	1.199 (30.45)	1.092 (27.74)	.118 (3.00)	.062 (1.57)±.006 (0.15)	PK-70873-055
74139-5540	40	.950 (24.13)	1.176 (29.87)	1.449 (36.80)	1.342 (34.09)	.118 (3.00)	.062 (1.57)±.006 (0.15)	PK-70873-055
74139-5660	60	1.450 (36.83)	1.676 (42.57)	1.949 (49.50)	1.842 (46.79)	.118 (3.00)	.062 (1.57)±.006 (0.15)	PK-70873-055
74139-5568	68	1.650 (41.91)	1.876 (47.65)	2.149 (54.58)	2.042 (51.88)	.118 (3.00)	.062 (1.57)±.006 (0.15)	PK-70873-055
74139-5569	68	1.650 (41.91)	1.876 (47.65)	2.149 (54.58)	2.042 (51.88)	.172 (4.37)	.116 (2.95)±.006 (0.15)	PK-70873-055
74139-5600	100	2.450 (62.23)	2.676 (67.97)	2.949 (74.90)	2.842 (72.19)	.118 (3.00)	.062 (1.57)±.006 (0.15)	PK-70873-055

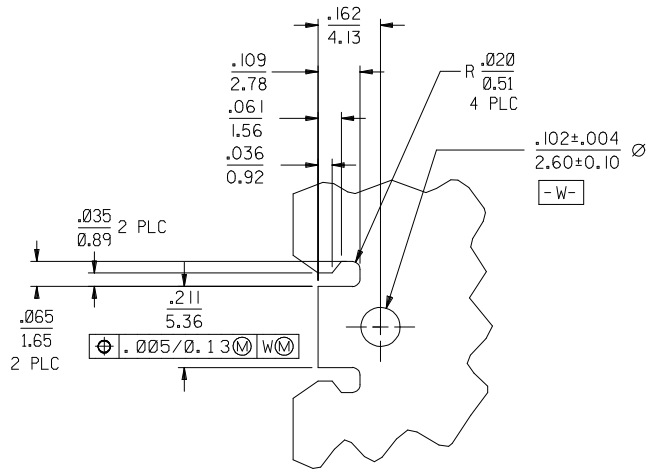

DETAIL FOR RECEPTACLE PCB LATCHING

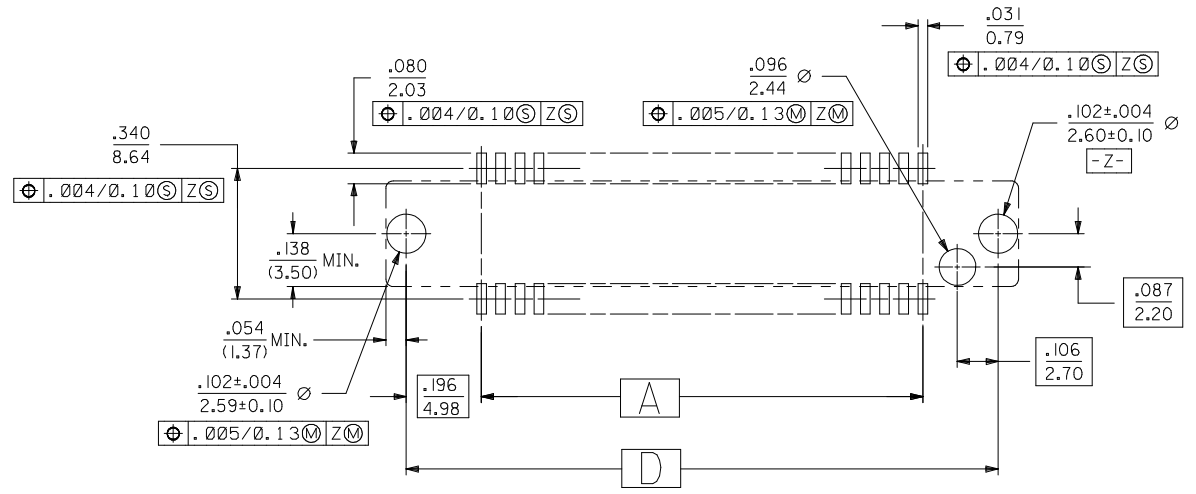

PCB LAYOUT: COMPONENT SIDE
SEE TABLE FOR RECOMMENDED PCB THICKNESS

SEE SHEET 1 EC NO: UCP2013-1178 DRAWN: PPOFF 2012/09/24 CHKD: BBARKER 2012/09/24 APPR: MILLER 2012/09/28	QUALITY SYMBOLS ▽=0 ▽=0 ▽=0	GENERAL TOLERANCES (UNLESS SPECIFIED)		DIMENSION STYLE IN/MM	SCALE	DESIGN UNITS INCH	THIRD ANGLE PROJECTION				
		4 PLACES ± --- ± ---	3 PLACES ± --- ± .005	2 PLACES ± 0.13 ± .01	1 PLACE ± 0.25 ± ---	0 PLACE ± --- ± ---	ANGULAR ±1/2°	MATERIAL NO. SEE TABLE	TITLE SALES ASSY EBBI 50D VERT SMT PLUG-WITH LATCHES, NO VAC CAP molex	DOCUMENT NO. SD-74139-002	SHEET NO. 2 OF 2
DRAFT WHERE APPLICABLE MUST REMAIN WITHIN DIMENSIONS		SIZE C		THIS DRAWING CONTAINS INFORMATION THAT IS PROPRIETARY TO MOLEX INCORPORATED AND SHOULD NOT BE USED WITHOUT WRITTEN PERMISSION							