

# EAO – Your Expert Partner for Human Machine Interfaces

18-147.035 - Pushbutton actuator

## 18-147.035 - Pushbutton actuator

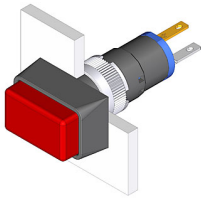

*Attention: The preview is based on a sample product. This can differ from your current configuration.*

### Mounting

Mounting cut-out Ø 8 mm  
Design raised

### Front

Front dimension 9 mm x 14 mm  
Front shape rectangular  
Front bezel colour black  
Front bezel material Plastic

### Other Attributes

Weight 0,002 kg

### Operating-/Indication part

Lens illumination illuminative

### IP-Rating

Front protection IP40

### Connection Method

Terminal Solder

### Actuator

Switching action Momentary  
Housing colour black  
Housing material Plastic

### Switching element

Switching system Snap-action switching element  
Contacts 1 NO  
Switching voltage 42 V AC/DC  
Switching current 0.1 A  
Contact material

### Function

Pushbutton

# EAO – Your Expert Partner for Human Machine Interfaces

18-147.035 - Pushbutton actuator

## Dimensions

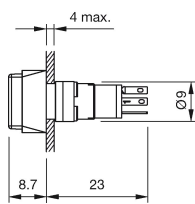

## Mounting cut-outs

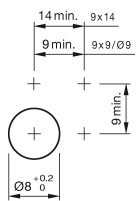

## Wiring diagram

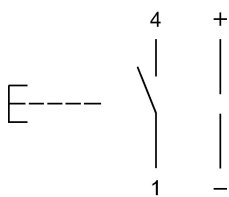

## Component layout

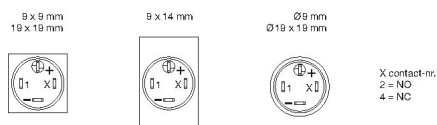

## Additional information

+/- terminals are not connected

## Legend

Contacts: NO = Normally open  
Switching action: B = Momentary