

EAO – Your Expert Partner for Human Machine Interfaces

19-030.005 - Indicator actuator

19-030.005 - Indicator actuator

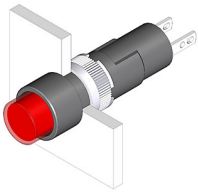

Attention: The preview is based on a sample product. This can differ from your current configuration.

Mounting

Mounting cut-out	Ø 8 mm
Behind panel depth	25 mm
Design	raised

Front

Front dimension	Ø 9 mm
Front shape	round

Other Attributes

Weight	0,001 kg
--------	----------

IP-Rating

Front protection	IP40
------------------	------

Connection Method

Terminal	Solder 2.0 x 0.5mm
----------	--------------------

Function

Indicator

Dimensions

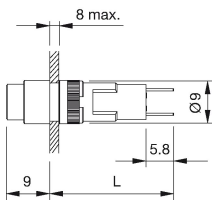

Mounting cut-outs

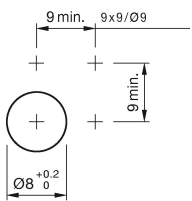

Wiring diagram



Component layout

9 x 9 mm

Ø9 mm

