

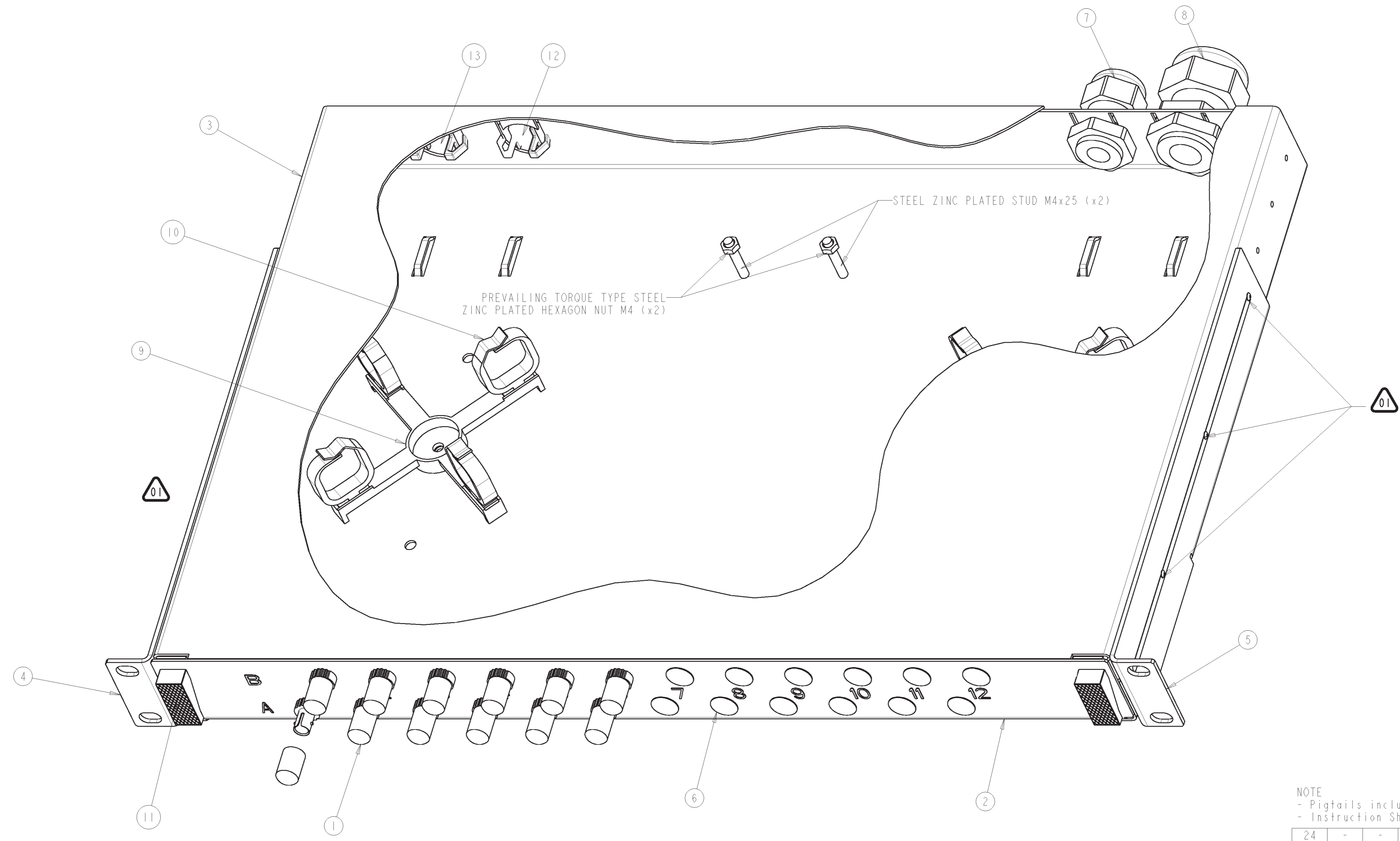



REVISIONS				
REV	DESCRIPTION	DATE	OWN	APPD
AN	ECN 800017777-REBRANDING	11-28-16	SC	JV



-  6 SCREWS M3x5 TAPTITE POS1 PAN ZINC PLATED INCLUDED WITH ENCLOSURE ASSY
-  SET OF 4 CAGE NUTS M6 AND 4 CROSS RECESSED PAN HEAD SCREWS DIN7985 H M6x12 - STEEL ZINC PLATED INCLUDED IN PLASTIC BAG
-  CABLE MANAGEMENT, CABLE GLANDS AND HOLE PLUGS INCLUDED IN PLASTIC BAG (SHOWN ON DRAWING IN SUGGESTED POSITION)
-  LASER LOGO AND LASER TEXT LABEL INCLUDED IN PLASTIC BAG

NOTE
 - Pigtails included not installed
 - Instruction Sheet 114NC-0018-3-07/05 included

24	-	-	-	5349569-4	PIGTAIL	14
1	1	1	1	-	M25 HOLE PLUG	13
1	1	1	1	-	M20 HOLE PLUG	12
2	2	2	2	-	SWELL LATCH	11
8	8	8	8	-	OFN SADDLE	10
2	2	2	2	-	CABLE MNGM. SPIDER	9
1	1	1	1	-	CABLE GLAND M25	8
1	1	1	1	-	CABLE GLAND M20	7
-	-	12	24	-	BLANKING PLUG ST-TYPE	6
1	1	1	1	-	R.H. BRACKET	5
1	1	1	1	-	L.H. BRACKET	4
1	1	1	1	-	COVER	3
1	1	1	1	-	TRAY	2
24	-	-	-	0-0504021-3	COUPLING RECEPTACLE KIT	1
-	24	12	-	0-0504021-1		
4--0	4--4	2--4	0--8		QUANTITY	
					PART NUMBER	
					DESCRIPTION	
					ITEM	

CUSTOMER DRAWING part N° : 1206114

DRAWING STATUS: **RELEASED** REVISION DESCRIPTION: - PN added.

DRAWING BY: H. BLEUS DATE: 07-FEB-03 DRAWING REVISION BY: H. BLEUS DATE: 31-OCT-08 VOLUME OF MOULDED PART OR AREA OF UNFOLDED SHEETMETAL PART: mm³ / mm²

SCALE: 1000 DRAWING FORMAT: A1 DRAWING TITLE: F.O. 1U PANEL 24 ST-STYLE MM

ISO-SYMBOL: GENERAL TOLERANCE: DRAWING SHEET, REVISION NUMBER: D_0010537_01.AN REVISION: AN

COMMSCOPE, INC.