

NOTES:

- 1) HOUSING MATERIAL: NYLON 6/6, U.L. 94V-2, COLOR: NATURAL.
 - 2) TERMINAL MATERIAL: BRASS, ALLOY 260.
 - 3) PART MATES WITH MINI-FIT JR. RECEPTACLES *42385 AND *42474.
 - 4) PART ALLOWS FOR UP TO .100/(2.54) MISALIGNMENT WITH MATING RECEPTACLE IN ANY DIRECTION. SEE MATING CONNECTOR DRAWINGS FOR SPECIFIC ALLOWANCES.
 - 5) PART IS DESIGNED IN METRIC.
 - 6) TERMINAL PLATING: .000100/(1.00254) MIN. TIN OVER .000050/(1.00127) MIN. NICKEL.
 - 7) CONNECTOR ASSEMBLIES ARE NOT TO BE MATED OR UNMATED WHILE CIRCUITS ARE LIVE.
- ⚠️ CIRCUITS 1 & 2 PROVIDE THE "MATE-FIRST/BREAK-LAST" FEATURE IN THIS CONNECTOR.

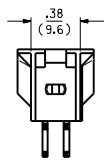

A-42404-04**

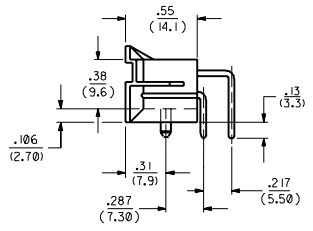
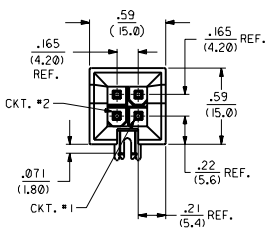
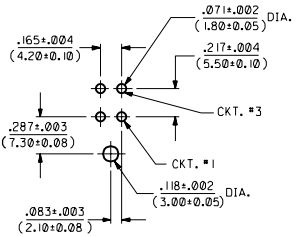
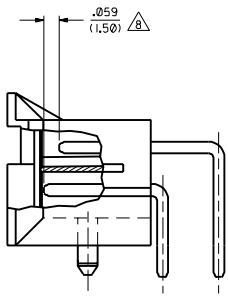

RECOMMENDED HOLE LAYOUT FOR .070/(1.78) MAX. THICK P.C. BOARD (SEE NOTE 5.)

LEGEND:

BASE NUMBER: A-43063-0401

CKT. SIZE: (02-24)

DIMENSIONS SHOWN METRIC UNLESS OTHERWISE SPECIFIED		MFG. SH. REV. LTR. REVISIONS	
TOLERANCES UNLESS OTHERWISE SPECIFIED		REVISE ONLY ON CAD SYSTEM	
FINISH	METRIC	TITLE	
F PLATE ± .010	---	4-CIRCUIT R.A. HDR. ASSY. (MATE-FIRST/BREAK-LAST)	
P PLATE ± .015 ± 0.25	---	MINI-FIT B.M.I. SERIES	
H PLATE ± .038	---	MOLLEX INCORPORATED	
DRIFT BONES ARE APPLICABLE UNLESS OTHERWISE SPECIFIED		PART NO. DATE	
DRG. R/J		15-24-8041 SDA-43063-0401	
APP'D. RAS		FILE NO. 10F12/10/92	
SCALE 2:1		THIS DRAWING IS THE PROPERTY OF MOLEX INC. IT IS TO BE USED ONLY IN WRITTEN PERMISSION OF MOLEX INC.	

B2 REV LEVEL UC1958 022 SAMIEC 98-4-1