

# 5mm x 20mm FUSE HOLDERS

5mm & 3AG FUSE HOLDERS

## SLIM LINE

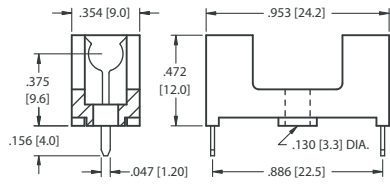

Mounting Detail

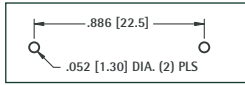

### SPECIFICATIONS

**Base & Cover:** Nylon,  
UL Rated 94V-0  
**Clips:** Brass, Tin Plate  
**Rated:** 5 Amps @ 250V AC

**CAT. NO. 4628 - Holder**

**CAT. NO. 4628C - Cover only** (with window)

- Optional cover with window protects and insulates fuse
- Flame Retardant

## LOW PROFILE

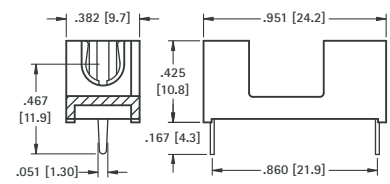

Mounting Detail

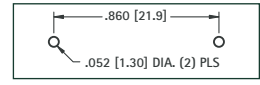

### SPECIFICATIONS

**Base & Cover:** Nylon,  
UL Rated 94V-0  
**Clips:** Brass, Tin Plate  
**Rated:** 5 Amps @ 250V AC

**CAT. NO. 4527 - Holder**

**CAT. NO. 4527C - Cover only**

- Low profile, space saving design
- Optional cover protects and insulates fuse
- Flame Retardant

## FULLY INSULATED

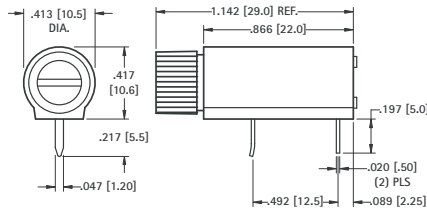

Mounting Detail

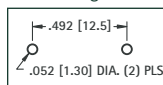

### SPECIFICATIONS

**Base:** PBT  
**Contacts:** Brass, Tin Plate  
**Rated:** 10 Amps @ 250V AC

**CAT. NO. 4525**

- Supplied unassembled
- Shock resistant
- Fuse can be accessed from board edge
- Fuse is completely enclosed, protecting use from shorting and breaking

## PC SNAP-IN

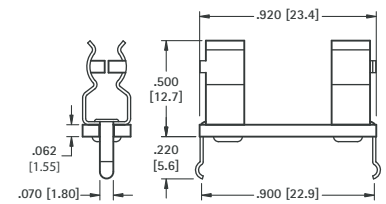
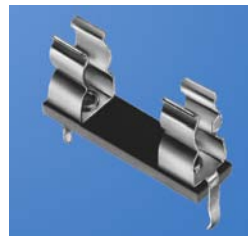

Mounting Detail

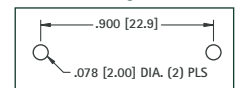

### SPECIFICATIONS

**Base:** .062 (1.57) G-10, UL Rated 94V-0  
**Clips:** Brass, Tin Plate  
**Rated:** 6.3 Amps @ 250V AC

**CAT. NO. 3527 - Holder**

- Snap-in design for wave soldering
- Flame Retardant
- Optional cover protects and insulates fuse - **Cat. No. 3527C**

# 3AG FUSE HOLDERS

## TERMINATION LUGS CAN BE USED WITH WIRES OR PC MOUNT

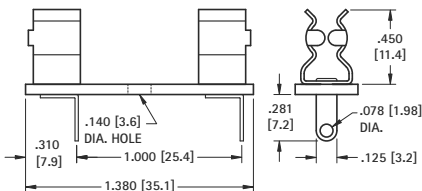

Mounting Detail

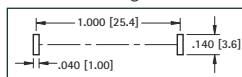

### SPECIFICATIONS

**Base:** .062 (1.57) GPO-3, UL Rated 94V-0  
**Clips:** Brass, Tin Plate  
**Rated:** 15 Amps @ 500VAC

**CAT. NO. 3526**

Optional cover available - **Cat. No. 4245C**

## PRESS-FIT, IDEAL FOR WAVE SOLDERING

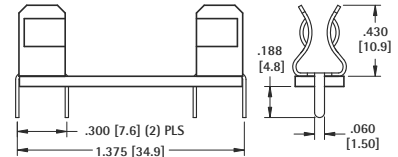

Mounting Detail

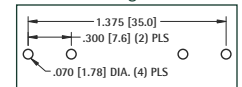

### SPECIFICATIONS

**Base:** .062 (1.57) GPO-3, UL Rated 94V-0  
**Clips:** Brass, Tin Plate  
**Rated:** 15 Amps @ 500VAC

**CAT. NO. 4245**

Optional cover available - **Cat. No. 4245C**

## SNAP-IN DESIGN ASSURES STABILITY DURING WAVE SOLDERING

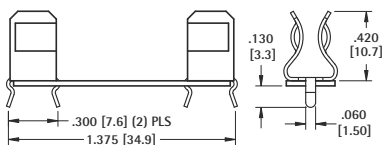

Mounting Detail

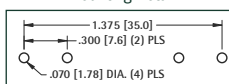

### SPECIFICATIONS

**Base:** .032 (1.57) G-10, UL Rated 94V-0  
**Clips:** Brass, Tin Plate  
**Rated:** 15 Amps @ 500VAC

**CAT. NO. 4250**

Optional cover available - **Cat. No. 4245C**

## MOLDED CASE

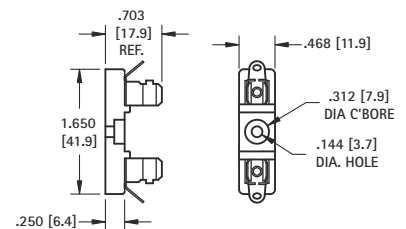

### SPECIFICATIONS

**Base:** LCP, UL Rated 94V-0  
**Clips:** .020 (.51) Brass - Nickel Plated  
**Rated:** 15 Amps @ 500 VAC

**CAT. NO. 3523**

Optional cover available - **Cat. No. 4245C**

Mounting Hole:  
.144 (3.7) Dia.

# MIDGET, SPF (5AG) FUSE HOLDER

- Designed for SPF (Solar Protection Fuse)
- Optional cover will protect and insulate fuse
- Flame resistant

## SPECIFICATIONS

**Base & Cover:** Nylon, UL Rated 94V-0

**Clips:** .030 (.76) Brass, Matte Tin Plate

**Rated:** 30 Amps

**Operating Temp. Range:** -58°F to +292°F (-50°C to +145°C)



3576 (THM)

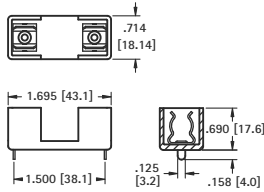

Optional Cover Cat. No. 3576C fits Cat. No. 3576 & 3574

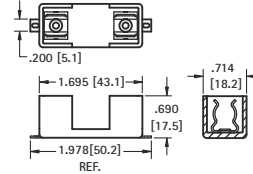

3574 (SMT)

### Mounting Detail

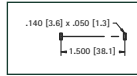

### Mounting Detail

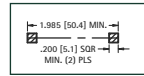

**CAT. NO. 3576 - Holder**

**CAT. NO. 3576C - Cover only**

**CAT. NO. 3574 - Holder**

**CAT. NO. 3576C - Cover only**

# 3AG FUSE BLOCKS

- Available with fiberglass or phenolic base
- Fuse clips riveted to base for rugged applications

## SPECIFICATIONS

**Phenolic Base:** XP, Black UL Rated 94-HB

**Fiberglass Base:** GPO-3 UL Rated 94 V-0

**Clips:** .020 (.51) Brass - Nickel Plated

**Rated:** 15 Amps @ 500 VAC

**Operating Temp. Range:** -58°F to +292°F (-50°C to +145°C)

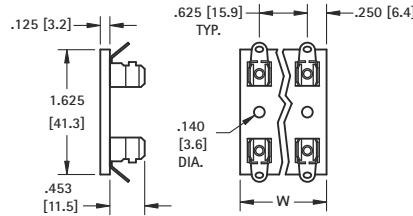

BLACK PHENOLIC	FIBER-GLASS	HOLDS NO. OF FUSES	W
<b>CAT. NO. 3536</b>	<b>3540</b>	1	.500 (12.7)
<b>3537</b>	<b>3541</b>	2	1.125 (28.6)
<b>3538</b>	<b>3542</b>	3	1.750 (44.5)
<b>3539</b>	<b>3543</b>	4	2.375 (60.3)

# FUSE COVERS

- Made from flame retardant material
- Protects fuse from shorting and minor bumps



Can be used with clips 3512, 3512P, 3517 and 3518

**MATERIAL:** ABS, UL Rated 94V-0

CAT. NO.	FUSE SIZE
<b>3517C</b>	5mm x 20mm

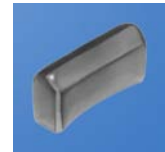
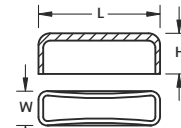
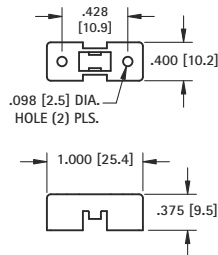

Can be used with clips or fuse holders

**MATERIAL:** PVC, UL Listed 94V-0

CAT. NO.	FUSE SIZE	L	W	H
<b>3527C</b>	5mm x 20mm	.945 (24.0)	.314 (8.0)	.512 (13.0)
<b>3521C</b>	2AG	.787 (20.0)	.295 (7.5)	.452 (11.5)
<b>4245C</b>	3AG	1.319 (33.5)	.472 (12.0)	.591 (15.0)

# SUBMINIATURE FUSE HOLDERS

- Reliable spring tension assures low contact resistance
- Fuse holders allow for quick changing of subminiature fuses
- Ideal for high density circuit board applications

## SPECIFICATIONS

**Base:** Thermoplastic, UL Rated 94V-0

**Springs:** Beryllium Copper, Gold Plate

**Pins:** Brass, Tin Plate

**Current Rating:** 5 Amps @ 250V AC



**.335 (8.5) x .158 (4.0) FUSE**

For Littelfuse 392/395 Type TE5®  
Bussmann: PC Series  
or equivalent



**.335 (8.5) DIA. FUSE**

For Littelfuse 370 Type TR5®  
Bussmann: BK-EFF series  
or equivalent



### STURDI-MOUNT

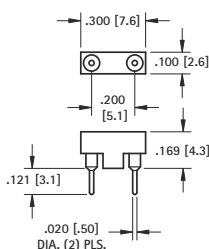

**CAT. NO. 3552**

### LOW PROFILE

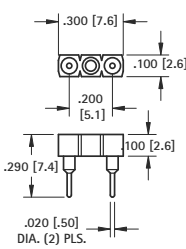

**CAT. NO. 3553**

### STURDI-MOUNT

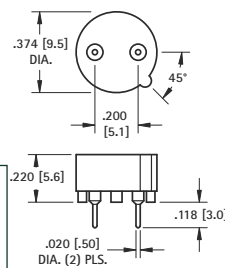

**CAT. NO. 3556**

### LOW PROFILE

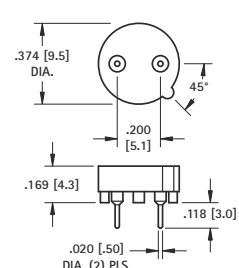

**CAT. NO. 3554**

# FUSE CLIPS

**Underwriters Laboratories, Inc.**  
**Recognized Component Program –**  
**UL File Number E354010**

UL file number E354010 has been assigned to Keystone Electronics' fuse clips with end stops. (Refer to pages 44-45) Indicating recognition by Underwriters Laboratories Inc. that they are in compliance with their component program.

- Available for 5mm, 1AG, 2AG, 3AG, 5AG, 7AG & 8AG sizes
- Low profile, space saving
- Low contact resistance
- Withstands shock and vibration
- Rated 6.3 to 30 Amps
- Custom designs and modifications available to your specifications

## PC THRU MOUNT TYPES

- Snap-fit design enhances assembly and PC retention for wave soldering
- Available with orientation legs to assure proper PC installation
- Available with or without end stops

## SURFACE MOUNT & RIVET TYPES

- Available with solder lugs or quick-fit tabs .187 (4.7), .205 (5.2)

Refer to pages 46-47 for Fuse Clip Layout and Mounting Details

### 5mm PC Clips

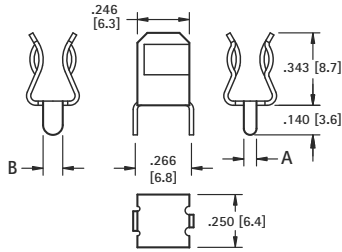
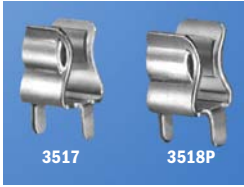

#### MATERIAL:

.020 (.51) Brass, Tin Plate  
**Current Rating:** 15 Amps

CAT. NO.	A	B
3517	.060 (1.5)	.060 (1.5)
3518P	.060 (1.5)	.093 (2.4)

#### With or Without Orientation Legs

Optional cover available - Cat. No. 3517C

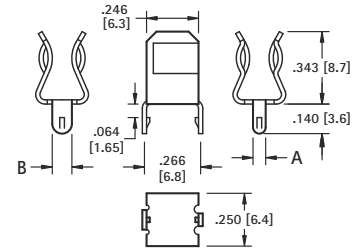

- With snap-in PC legs

#### MATERIAL:

.020 (.51) Brass, Tin Plate  
**Current Rating:** 15 Amps

CAT. NO.	A	B
3512	.060 (1.5)	.060 (1.5)
3512P	.060 (1.5)	.093 (2.4)

#### With or Without Orientation Legs

Optional cover available - Cat. No. 3517C

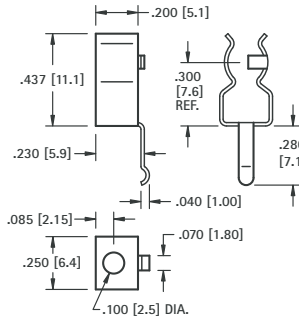

#### MATERIAL:

.016 (.41) Brass, Tin Plate  
**Current Rating:** 6.3 Amps

**CAT. NO. 3520**

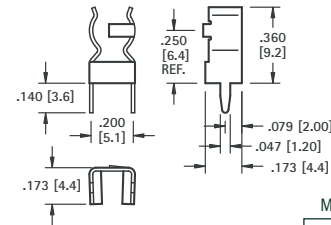

#### MATERIAL:

.016 (.41) Brass, Tin Plate  
**Current Rating:** 15 Amps

**CAT. NO. 3519**

#### Mounting Detail

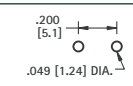

FUSE CLIPS

### 2AG or 5mm

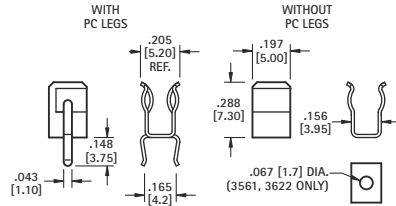

**MATERIAL:** .016 (.41) Brass, Tin Plate  
**Current Rating:** 15 Amps

CAT. NO.	PC LEGS	END STOP
3521	YES	YES
3621	YES	NO*
3561	NO	YES
3622	NO	NO*

Mounting Detail  
 Cat. No. 3521 & 3621 Only

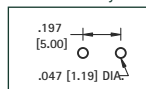

### 5mm/3AG

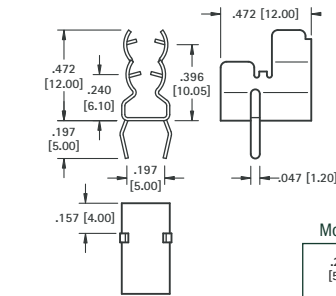

#### MATERIAL:

.016 (.41) Brass, Tin Plate  
**Current Rating:** 15 Amps

**CAT. NO. 3562**

#### Mounting Detail

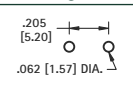

### 4AG (9/32 Dia.)

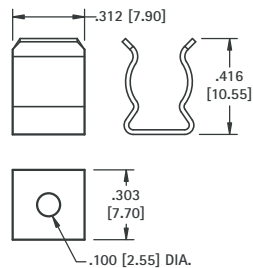
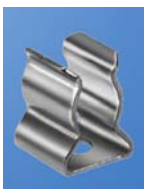

#### MATERIAL:

.020 (.51) Brass, Nickel Plate  
**Current Rating:** 15 Amps

**CAT. NO. 3565 (Without End Stops)\***

### 5AG (13/32 Dia.) - Solar Protection Fuse

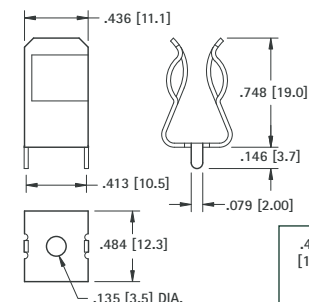

#### MATERIAL:

.030 (.76) Brass, Tin Plate  
**Current Rating:** 30 Amps

**CAT. NO. 3566**

#### Mounting Detail

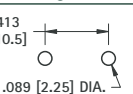

\*Fuse clips without end stops are not UL recognized

Refer to pages 46-49 for Fuse Clip Layout and Mounting Details

## 1AG, 3AG, 7AG, 8AG THRU HOLE MOUNT TYPES

### WITH SNAP-IN PC LEGS



**MATERIAL:**  
.020 (.51) Brass, Tin Plate  
**Current Rating:** 15 Amps

**CAT. NO. 3513**

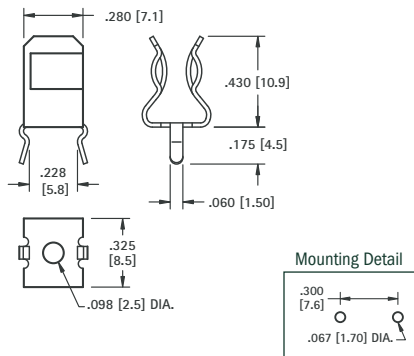

### WITH SNAP-IN PC LEGS

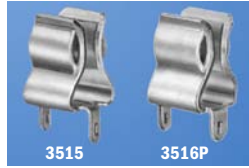

**MATERIAL:**  
.020 (.51) Brass, Tin Plate  
**Current Rating:** 15 Amps

CAT. NO.	A	B
<b>3515</b>	.060 (1.5)	.060 (1.5)
<b>3515P</b>	.060 (1.5)	.093 (2.4)
<b>3516P</b>	.060 (1.5)	.120 (3.0)

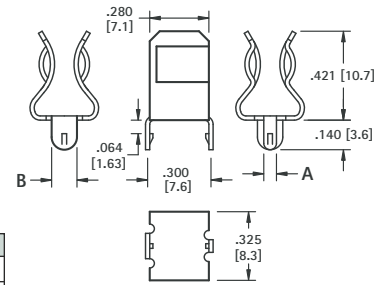

With or Without Orientation Legs

### WITH STRAIGHT PC LEGS



**MATERIAL:**  
.020 (.51) Brass, Tin Plate  
**Current Rating:** 15 Amps

**CAT. NO. 3530**

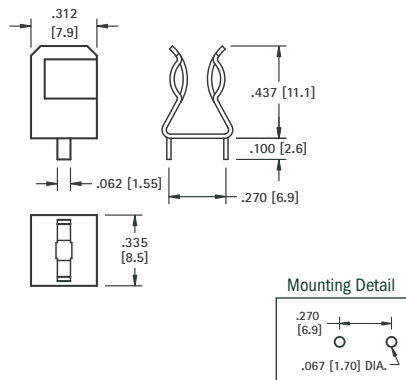

### WITH STRAIGHT PC LEGS



**MATERIAL:**  
.020 (.51) Brass, Tin Plate  
**Current Rating:** 15 Amps

CAT. NO.	H	L	END STOPS
<b>3510</b>	.421 (10.7)	.140 (3.6)	NO*
<b>3529</b>	.421 (10.7)	.140 (3.6)	YES
<b>3511</b>	.430 (10.9)	.250 (6.4)	NO*
<b>3514</b>	.430 (10.9)	.250 (6.4)	YES

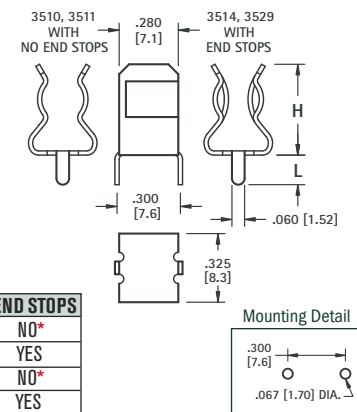

### WITH SOLDER LUG



**MATERIAL:**  
.020 (.51) Brass, Nickel Plate  
**Current Rating:** 15 Amps

CAT. NO.	A	B
<b>3533</b>	Flat	.656 (16.7)
<b>3535</b>	45°	.562 (14.3)
<b>3570</b>	-	NO TAB

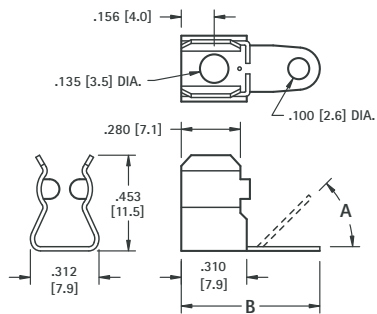

### LOW PROFILE

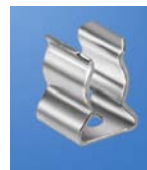

**MATERIAL:**  
.020 (.51) Brass, Nickel Plate  
**Current Rating:** 15 Amps

**CAT. NO. 3531** (Without End Stops)\*

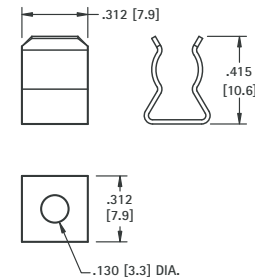

### WITH QUICK-FIT TAB



**MATERIAL:**  
.020 (.51) Brass, Nickel Plate  
**Current Rating:** 15 Amps

CAT. NO.	TAB
<b>4246</b>	.187 (4.7)
<b>4247</b>	.205 (5.2)

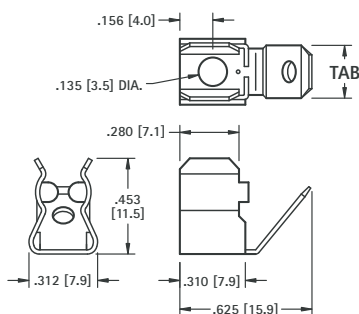

### WITH OR WITHOUT END STOPS



**MATERIAL:**  
.020 (.51) Brass, Nickel Plate  
**Current Rating:** 15 Amps

CAT. NO.	END STOPS
<b>3532</b>	YES
<b>3567</b>	NO*

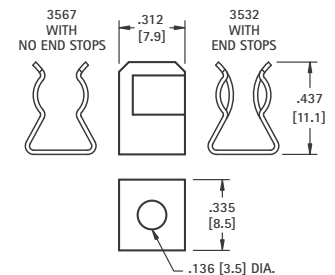

\*Fuse clips without end stops are not UL recognized