

EAO – Your Expert Partner for Human Machine Interfaces

10-2112.1069 - Single-LED

10-2112.1069 - Single-LED



Attention: The preview is based on a sample product. This can differ from your current configuration.

Other Attributes

Weight	0,001 kg
Operation current	2,5 / 5 mA \pm 15 %
Operating voltage	24 V AC/DC +10 %

Illumination

Socket	T5.5
LED colour	white

Optics

Lumi. intensity	750 mcd
Dom. wavelength	x0.31/y0.32 nm

Dimensions

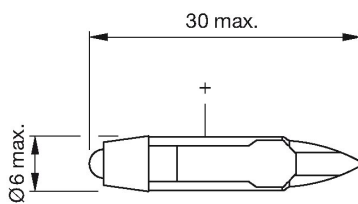

Additional information

When using AC/DC types with AC operation, slight flickering can occur

Luminous intensity data of the LEDs on direct voltage

Electrical and optical data are measured at 25 °C

The specified versions are built with a protection diode (half wave rectifier) in series and the LED

Luminosity and wave length variations caused by LED manufacturing processes may cause slight differences regarding the illumination

For supply voltages above 48 V, it is necessary to use a voltage reduction element (external series resistor or transformer)