

# EAO – Your Expert Partner for Human Machine Interfaces

## 51-388.F22D - Keylock switch 3 positions

### 51-388.F22D - Keylock switch 3 positions

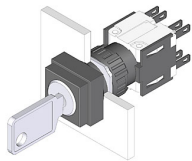

*Attention: The preview is based on a sample product. This can differ from your current configuration.*

#### Mounting

Mounting cut-out                    Ø 16 mm  
Design                                    raised

#### Front

Front dimension                    18 mm x 18 mm  
Front shape                            square

#### Other Attributes

Weight                                    0,025 kg

#### Operating-/Indication part

Switching angle

#### IP-Rating

Front protection                    IP65

#### Connection Method

Terminal                                Solder 2.8 x 0.5 mm

#### Actuator

Switching action                    Maintain(a) - Rest(a) - Momentary

#### Switching element

Rotary positions                    3  
Switching system                    Snap-action switching element  
Switching current                    5 A  
Contacts                                2 NC + 2 NO  
Contact material  
Switching voltage                    250 V AC

#### Function

Keylock switch

# EAO – Your Expert Partner for Human Machine Interfaces

## 51-388.F22D - Keylock switch 3 positions

### Dimensions

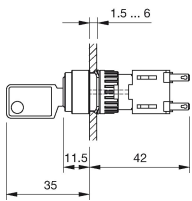

### Mounting cut-outs

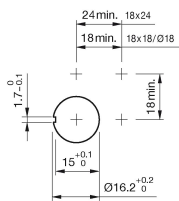

### Wiring diagram

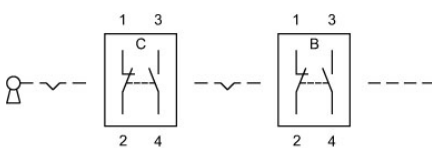

### Switching positions

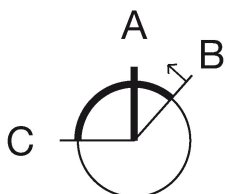

### Additional information

Standard lock: DOM 311

Two keys are supplied with each key lock switch

Optional lock numbers on request

### Legend

Contacts: NC = Normally closed, NO = Normally open

Switching action: A = Rest, B = Momentary, C = Maintained