

4

3

2

1

THIS DRAWING IS UNPUBLISHED.

RELEASED FOR PUBLICATION

© COPYRIGHT

ALL RIGHTS RESERVED.

LOC DIST

REVISIONS

P	LTR	DESCRIPTION	DATE	DWN	APVD

REPLACED BY OCEAN STYLE APPLICATOR PART NUMBER

FOR REPLACEMENT PARTS FOR APPLICATOR REFER TO ADDITIONAL PAGE(S). SPARE PARTS KIT (IF LISTED) WILL REMAIN AVAILABLE.

THE REPLACEMENT OCEAN STYLE APPLICATOR HAS THE SAME TERMINATOR/PRESS INTERFACE AS APPLICATOR

THIS DRAWING IS A CONTROLLED DOCUMENT.		DWN	 TE Connectivity			
DIMENSIONS:		CHK				
		APVD	NAME			
TOLERANCES UNLESS OTHERWISE SPECIFIED:		PRODUCT SPEC	APPLICATION SPEC			
0 PLC ± 1 PLC ± 2 PLC ± 3 PLC ± 4 PLC ± ANGLES ±		WEIGHT	SIZE	CAGE CODE	DRAWING NO	RESTRICTED TO
MATERIAL	FINISH		A3		C-	
		SCALE	SHEET	OF	REV	

PART NUMBER	REV	FIRST USED	TERMINATOR	FEED TYPE	DESCRIPTION
1426593-1	A	-	LEADMAKER	MECH POST FEED	CUTS CARRIER
1426593-2	A	-	BENCH	MECH PRE FEED	CUTS CARRIER
1426593-6	A	-	LEADMAKER	MECH POST FEED	CONTINUOUS CARRIER
7-1426593-1	A	-	LEADMAKER	MECH POST FEED	-1 AND SPARE PARTS
7-1426593-2	A	-	BENCH	MECH PRE FEED	-2 AND SPARE PARTS
7-1426593-6	A	-	LEADMAKER	MECH POST FEED	-6 AND SPARE PARTS
7-1426593-7	A	-	-	-	SPARE PARTS KIT

CRIMP DATA AMP TERMINAL		AMP CRIMP SPECS	
TERMINAL NAME: CONTACT, RECEPT, CRIMP SNAP-IN, MICRO MATE-N-LOCK			
CRIMP	SIZE	TYPE	RANGE
WIRE	1.07 [.042 IN]	F	30 - 26 AWG
INSUL	1.78 [.070 IN]	F	0.89-1.52 [.035-.060 IN]
WIRE STRIP LENGTH		APPL INSTRUCTION	
2.90-3.53 [.114-.139 IN]		408-8322	
TERMINAL		FEED	
APPL SPEC 114-13000		6.35 [.250 IN]	
TERMINALS APPLIED			
794607	-	-	-
-	-	-	-
-	-	-	-
-	-	-	-
-	-	-	-
-	-	-	-
-	-	-	-
WIRE SIZE	CRIMP HEIGHT	PIN PN AND LENGTH [IN]	
mm ² AWG			
26 AWG	0.61 ±0.05 [.024 ±.002 IN]	6-354779-9 [.3335]	
28 AWG	0.56 ±0.05 [.022 ±.002 IN]	7-354779-3 [.3355]	
30 AWG	0.51 ±0.05 [.020 ±.002 IN]	7-354779-7 [.3375]	

- ① RECOMMENDED SPARE PARTS.
- 2. GREASE RAM, CAM, CAM FOLLOWER AND FEED ROD LIGHTLY.
- 3. LUBRICATE DAILY PER THE APPLICATOR INSTRUCTION SHEET SUPPLIED WITH THE APPLICATOR.
- ④ CERTAIN TERMINALS REQUIRE LUBRICATION. REFER TO THE APPLICATOR INSTRUCTION SHEET FOR MORE INFORMATION.
- ⑤ CUT TO LENGTH AT ASSY.

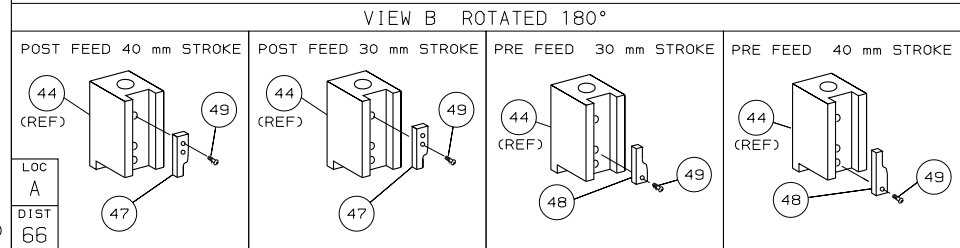

AMP 1756 REV 3-92 09-MAR-06 14:54:43 eb003653

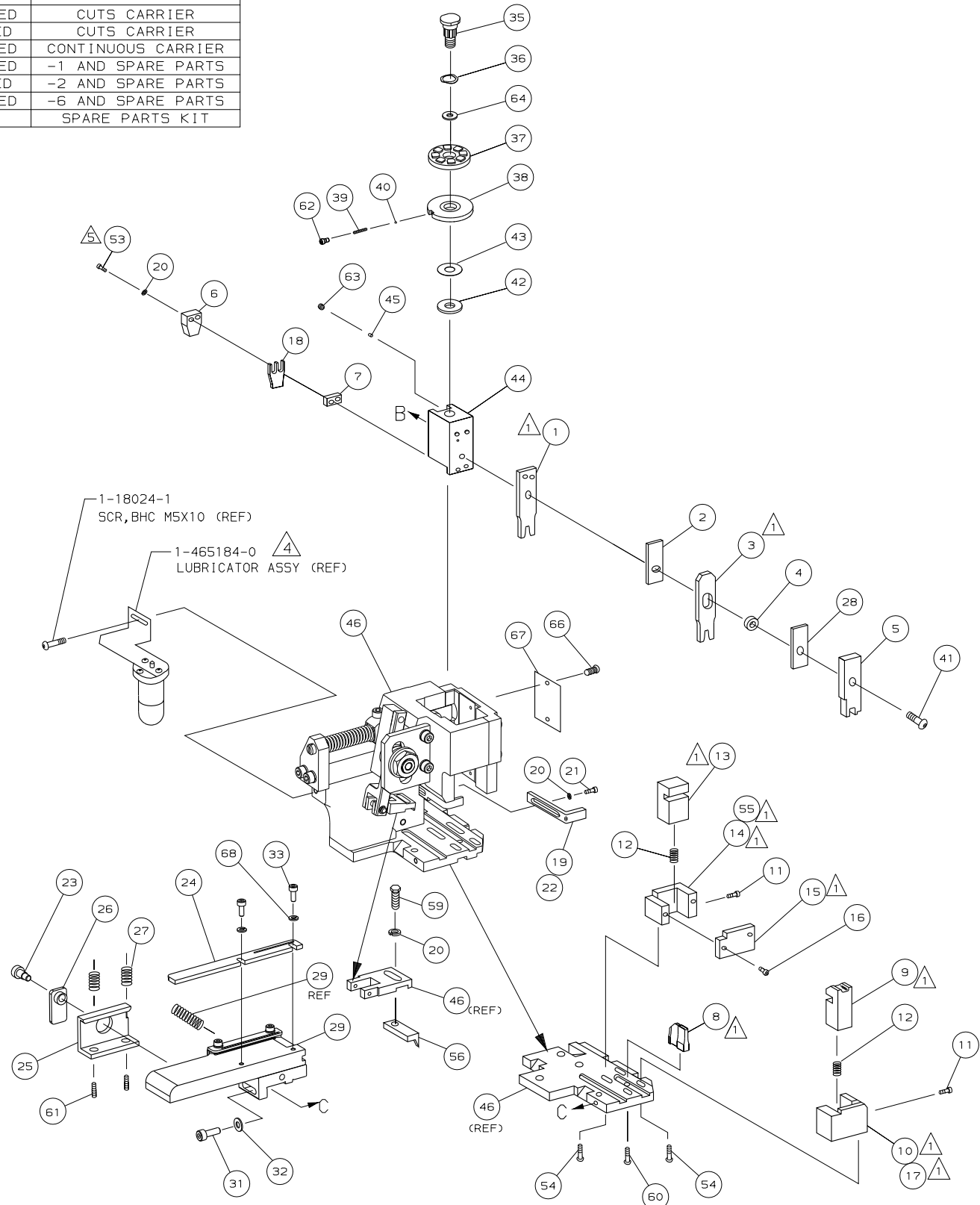

QTY	REQD	PER	ASSY	PART NO	DESCRIPTION	ITEM NO		
-	1	1	1	1	1	1426593	PRINT, APPLICATOR LOG SHEET	73
-	1	1	1	1	1	1338705-1	DOCUMENTATION PACKAGE	72
-	2	2	2	2	2	18025-1	WASHER, LOCK (M3) STP GDE R	71
-	1	1	1	1	1	461264-1	PLATE, IDENTIFICATION	70
-	2	2	2	2	2	21017-2	SCR, DRIVE (#2X.19) ID PLATE	69
-	1	1	1	1	1	986950-1	WASHER, FLAT PRECISION	68
-	1	1	1	1	1	3-18031-0	SCR, SKT SET (M6X6) RAM	67
-	1	1	1	1	1	18023-9	SCR, SHC (M4X6) INS DISC	66
-	2	2	2	2	2	2-18032-5	SCR, SKT SET (M5X20) DRAG	65
-	1	1	1	1	1	18024-7	SCR, BHC (M4X10) ANVIL	64
-	1	1	1	1	1	5-18022-2	SCR, HEX (M4X8) FEED FINGER	63
-	1	1	1	1	1	1338683-1	PAWL, FEED	62
-	1	-	-	-	-	1338723-1	HOLDER, SHEAR, REAR (NO CUT)	61
-	4	4	4	4	4	18024-8	SCR, BHC (M4X12) SHEAR HOLDER	60
-	2	2	2	2	2	1-18023-4	SCR, SHC (M4X20) TERM HLD DWN	59
-	1	1	1	1	1	18024-3	SCR, BHC (M3X10) CAM	58
-	1	-	-	-	-	1338675-1	CAM, PRE FEED 30 & 40 mm ST	57
-	1	-	-	-	-	1338676-1	CAM, POST FEED 30 & 40 mm ST	56
-	1	1	1	1	1	1320999-3	APPLICATOR BASIC SUBASSY	55
-	1	1	1	1	1	690191-1	PLUG, NYLON	54
-	1	1	1	1	1	1338660-3	RAM	53
-	1	1	1	1	1	690125-1	WASHER, LAMINATED	52
-	1	1	1	1	1	690124-1	WASHER, RAM	51
-	1	1	1	1	1	2-18024-6	SCR, BHC (M8X25) RAM	50
-	1	1	1	1	1	23241-1	BALL, STEEL	49
-	1	1	1	1	1	2-22278-7	SPRING, COMPRESSION	48
-	1	1	1	1	1	1320922-1	DISC, INSULATION	47
-	1	1	1	1	1	354777-1	WIRE DISC, PLASTIC	46
-	1	1	1	1	1	22480-5	WASHER, SPRING	45
-	1	1	1	1	1	690212-1	POST, RAM	44
-	2	2	2	2	2	18023-5	SCREW, SHC (M3X12) FR STP GDE	43
-	1	1	1	1	1	18027-2	WASHER, FLAT (M4)	42
-	1	1	1	1	1	1-18023-2	SCR, SKT CAP (M4X12) MOUNT BLOCK	41
-	1	1	1	1	1	1633082-1	STRIP GUIDE PLATE ASSY	40
-	1	1	1	1	1	1-455888-8	SPACER, FRONT SHEAR DEP	39
-	2	2	2	2	2	1-22284-0	SPRING, DRAG	38
-	1	1	1	1	1	356835-1	LEVER, DRAG RELEASE	37
-	1	1	1	1	1	240792-1	DRAG, TERMINAL	36
-	1	1	1	1	1	189124-7	GUIDE, STRIP (FRONT)	35
-	1	1	1	1	1	980371-4	SCR, SHC SHLD	34
-	1	-	-	-	-	690472-2	STRIPPER	33
-	1	1	1	1	1	1-18023-1	SCR, SHC (M4X10) STRIPPER	32
-	4	4	4	4	4	18025-2	WASHER, LOCK (M4) STRIPPER	31
-	-	-	-	-	-	691353-1	STRIPPER	30
-	1	1	1	1	1	2-690518-4	HOLDER, TERMINAL	29
-	1	-	-	-	-	1338684-1	HOLDER, SHEAR, FRONT (NO-CUT)	28
-	2	2	2	2	2	18023-2	SCR, SHC (M3X6) REAR SHEAR PL	27
-	1	1	1	1	1	1-690691-1	PLATE, SHEAR (REAR)	26
-	-	-	-	-	-	1320920-1	HOLDER, SHEAR, REAR (CUT)	25
-	1	1	1	1	1	690463-1	SHEAR, FLOAT (REAR)	24
-	2	2	2	2	2	5-22280-0	SPRING, SHEAR	23
-	2	2	2	2	2	356885-4	STOP, SHEAR	22
-	-	-	-	-	-	1320921-1	HOLDER, SHEAR, FRONT (CUT)	21
-	1	1	1	1	1	462006-1	SHEAR, FLOAT (FRONT)	20
-	1	2	2	2	2	5-1333200-0	ANVIL	19
-	1	1	1	1	1	3-240641-5	SPACER, DEPRESSOR (REAR)	18
-	1	1	1	1	1	690468-2	DEPRESSOR, SHEAR (REAR)	17
-	1	1	1	1	1	2-455889-0	DEPRESSOR, SHEAR (FRONT)	16
-	1	1	1	1	1	2-238011-0	SPACER, BLOCK CRIMPER	15
-	1	2	2	2	2	2-683453-0	CRIMPER, INSULATION	14
-	1	1	1	1	1	455888-4	SPACER, CRIMPER	13
-	1	2	2	2	2	456401-4	CRIMPER, WIRE	12

QTY REQD PER ASSY

REVISION OF EACH ASSY NO (WHEN BLANK, USE DWG REVISION)

PARTS LIST

DO NOT SCALE PRINT. TOLERANCES UNLESS OTHERWISE SPECIFIED.

DR L.LOFTHOUSE 26JAN06 APP M.CLIFFORD 26JAN06

CHK - REL 09MAR06 L.LOFTHOUSE

NAME SIDE FEED HD-I APPLICATOR MACHINE REF HD-I APPL

SCALE - DWG NO 1426593 SHEET 1 of 1 REV A

REMOVE BURRS SHARP EDGES RO.3B MAX

CHE CODE 00779 CUSTOMER AND ASSEMBLY DRAWING